

# ELLE MACPHERSON THE BODY™



## Hot Wax Epilator

**2 Year Guarantee**

---

Instruction Manual

By  
**HOMEDICS®**

ELM-HWX100-GB



Thank you for purchasing this Hot Wax Epilator part of my 'The Body' range that I have developed so that you can maximise your beauty potential. Intuitive and accessible, my range of products can help you to discover some of my beauty secrets.

The great thing about my Hot Wax Epilator are the salon quality results, but in the comfort of your own home. Especially when it's that time of year to get your legs out, you want a good hair removal solution. This easy to use handheld unit heats up quickly to the perfect temperature to get maximum effects. Not only that, the aloe vera infused wax makes sure it looks after even the most sensitive skin, keeping your skin looking fresh and smooth.

Enjoy showing off your beautifully silky smooth skin!

Elle ☺

**READ ALL INSTRUCTIONS BEFORE USE.  
SAVE THESE INSTRUCTIONS FOR FUTURE REFERENCE.**

## **IMPORTANT SAFEGUARDS:**

**WHEN USING ELECTRICAL PRODUCTS, ESPECIALLY WHEN CHILDREN ARE PRESENT, BASIC SAFETY PRECAUTIONS SHOULD ALWAYS BE FOLLOWED, INCLUDING THE FOLLOWING:**

- ALWAYS unplug the appliance from the electrical outlet immediately after using and before cleaning. To disconnect, turn all controls to the 'OFF' position, then remove plug from outlet.
- NEVER leave an appliance unattended when plugged in. Unplug from the mains outlet when not in use and before putting on or taking off parts or attachments.
- This appliance can be used by children aged from 14 years and above and persons with reduced physical, sensory or mental capabilities or lack of experience and knowledge if they have been given supervision or instruction concerning use of the appliance in a safe way and understand the hazards involved. Children shall not play with the appliance. Cleaning and user maintenance shall not be made by children without supervision.
- DO NOT reach for an appliance that has fallen in water or other liquids. Switch off at the mains and unplug it immediately.
- NEVER insert pins or other metallic fasteners into the appliance.
- Use this appliance for the intended use as described in this booklet. DO NOT use attachments not recommended by HoMedics.
- NEVER operate the appliance if it has a damaged cord or plug, if it is not working properly, if it has been dropped or damaged, or dropped into water. Return it to the HoMedics Service Centre for examination and repair.
- Keep cord away from heated surfaces.
- Excessive use could lead to the product's excessive heating and shorter life. Should this occur, discontinue use and allow the unit to cool before operating.
- NEVER drop or insert any object into any opening.
- DO NOT operate where aerosol (spray) products are being used or where oxygen is being administered.
- DO NOT operate under a blanket or pillow. Excessive heating can occur and cause fire, electrocution or injury to persons.
- DO NOT carry this appliance by the cord or use cord as a handle.
- DO NOT use outdoors.
- This product requires a 220-240 V AC power.
- DO NOT attempt to repair the appliance. There are no user serviceable parts. For service, send to a

HoMedics Service Centre. All servicing of this appliance must be performed by authorised HoMedics service personnel only.

- Never block the air openings of the appliance or place it on a soft surface, such as a bed or couch. Keep air openings free of lint, hair etc.
- Do not place or store appliance where it can fall or be pulled into a bath or sink. Do not place in or drop into water or other liquid.
- Always use the adaptor supplied with the appliance. Do not use the appliance in combination with other types of adaptors.

## SAFETY CAUTIONS :

### PLEASE READ THIS SECTION CAREFULLY BEFORE USING THE APPLIANCE.

- If you have any concerns regarding your health, consult a doctor before using this appliance.
- If you are susceptible to allergic reactions or if you have circulatory problems, consult a physician before using this product.
- Do not use on irritated, sunburned or chapped skin, or on any area with dermatological problems.
- Do not apply over skin eruptions, warts, moles or varicose veins.
- Use should be easy and painless. If you experience nail or skin irritation, or hand discomfort when using this product, discontinue use. If a more extreme reaction occurs, consult your doctor
- Individuals with pacemakers and pregnant women should consult a doctor before using this appliance. Not recommended for use by Diabetics
- DO NOT use on an infant, invalid or on a sleeping or unconscious person. DO NOT use on insensitive skin or on a person with poor blood circulation.
- If you feel any discomfort whilst using this appliance, discontinue use and consult your doctor.
- Care should be taken when using heated surfaces. If the product feels excessively hot, switch off at mains and contact the HoMedics Service Centre.
- Designed for use on legs, arms, underarms and bikini line, not suitable for use on the face, head, breast, perianal or genital areas or any other body parts
- Ensure that your hands are dry when operating the controls or removing the plug.  
This product should NEVER be used by any individual suffering from any ailments that would limit the user's capacity to operate the controls.
- Store the wax cartridge upright.
- Store away from a heat source and keep away from a naked flame.
- Keep out of reach of children. In case of ingestion, do not induce vomiting, consult a doctor immediately. In case of contact with the eye, consult a doctor immediately.
- The appliance should never be plugged in without a wax cartridge refill in it.
- This product is only intended for at home use applications.
- The 2 year guarantee won't be valid if the device has been used with any others wax cartridge refills than the supplied or recommend one.

### Plug (ELM-HWX100-GB ONLY)

If the plug on this appliance is damaged, it can be replaced with a BS 1363 plug, fitted with a 3A BS 1362 fuse. Only use a 3 amp fuse with this appliance. Care must be taken when changing the plug. If in doubt, contact a qualified electrician.

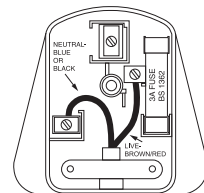

### WEEE explanation

 This marking indicates that this product should not be disposed with other household wastes throughout the EU. To prevent possible harm to the environment or human health from uncontrolled waste disposal, recycle it responsibly to promote the sustainable reuse of material resources. To return your used device, please use the return and collection systems or contact the retailer where the product was purchased. They can take this product for environmental safe recycling.

## PRODUCT FEATURES:

The Elle Macpherson Hot Wax Epilator is clean, quick and easy to use. The roller applicator ensures that the warm wax is easy to apply.



**Wax heating handset:** Easy to hold and apply, no trailing power cord during use.

**Lid:** Keeps the wax applicator clean and dust free between uses.

**Mains powered docking unit and power cord:** Heats the wax ready for use, within 20-30 minutes. LED light indicates when the wax is at the optimum temperature. Wax temperature is maintained at a safe and comfortable temperature.

**Wax cartridge with roller applicator:** One cartridge lasts up to 8 wax sessions (1 session = based on depilation of both half legs). Replacement wax cartridges (ELM-HWX101-EU) available from [www.homedocs.co.uk](http://www.homedocs.co.uk).

**Wax strips x 50 sheets:** to remove the wax and hair from the skin.

## INSTRUCTIONS FOR USE

### Patch test

It is recommended to carry out a patch test on a small area of skin on the inside of your forearm to ensure there are no adverse reactions to the wax. Wait 24 hours and if irritation occurs do not use this product.

### Before treatment

- For best results ensure hairs are between 5-8mm in length, but hair should be at least 2-5mm in length.
- Ensure the treatment area is clean, dry and free of make-up and grease. It is recommended to wash and dry the area to remove the body's natural oils and improve adhesion of the wax to the hairs.
- The wax is difficult to remove from clothing, upholstery etc. take care to avoid contact with these surfaces.

**Please note:** If you have not waxed before, we recommend starting by removing hair from the legs. Only when you have experience then progress to the sensitive areas such as underarm or bikini line. We recommend not to wax the same area of skin twice during a waxing session.

## PREPARING THE PRODUCT FOR USE

1. Place the mains powered base unit on a flat and stable work surface and plug into the mains power supply. The LED will illuminate green to indicate that power is on.
  2. Take the wax cartridge and remove the protective seal. Take the lid off the handset and insert the cartridge. (Fig. 1)
  3. Insert the handset into the base unit. The LED will turn red and flash to indicate that the unit is heating up. NOTE Do not attempt to remove the wax cartridge once it has started heating up. Do not insert the handset onto the base unit without the wax cartridge installed.
  4. Wait for 20-30 minutes for the wax to heat to the appropriate temperature. Once the correct temperature is reached the LED will stop flashing and illuminate red. The wax is now ready to use.
  5. Remove the handset from the base unit (the LED on the base unit will then turn green)
  6. Before applying to the skin, first test the wax applicator on a piece of paper to achieve an even flow of wax over the roller head and check the temperature of the wax. If it feels too hot, allow to cool for a few minutes before applying to the skin.
  7. Hold the handset at 45 degrees next to the treatment area. Begin rolling the wax over the skin following the direction of hair growth. Ensure the area covered is no longer or wider than the size of the wax strip. Place the handset back in the base unit inbetween applications to help maintain the wax temperature. (Fig. 2)
  8. Immediately after, fold over approx. 5mm along the short edge of the wax strip. Firmly apply the wax strip over the applied wax with the folded edge facing up. Wait for approximately 20 seconds before removing the strip.
  9. Hold the skin taught and grip the folded edge of the strip. Remove with one quick movement following the opposite direction to hair growth (from ankle to knee for legs). Try to keep the strip close to the skin and parallel. Lifting the strip up will cause more pain and be less effective as the hairs will break without removing the root. The faster you remove the strip the more effective it will be. (Fig. 3)
  10. Apply firm pressure with the palm of the hand to the area and apply a cold compress to sooth if required.
  11. Repeat steps 7-10 until the treatment area is hair and wax free. The strip can be used until fully loaded with wax. When this occurs, discard and start a new piece. Any sticky residue left can be removed using baby oil (not included). Do not re-apply wax to treated area within 24 hours.
  12. After use, replace the handset in the base unit, cover the applicator with the lid and switch off at the mains.
  13. After use the refill wax cartridge will be hot – allow it to cool down before removing the refill from the device. If necessary, you can clean the roller head using the back of a used strip. Never use water or any other liquids to clean the device or roller head.
  14. If desired, a small amount of cling-film or foil can be used to cover the roller applicator between uses.
- NOTE:** It is not recommended that the product or wax cartridges are used by more than one person for hygiene reasons.
15. Always store the wax upright, away from a heat source. Keep away from a naked flame.

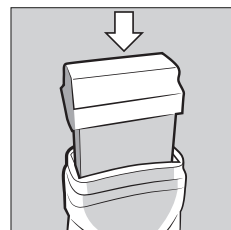

Fig. 1

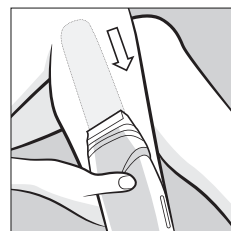

Fig. 2



Fig. 3

## RECOMMENDATIONS FOR DIFFERENT BODY AREAS

### Forearm and legs

- Start at the wrist or ankle and work up. Take note the direction of hair growth.
- The skin should be kept taut by bending the elbow/wrist/knees/ankle as appropriate.

### Bikini line (Fig. 4)

- It may be helpful to wear a swim suit or style of underwear to define how far you need to wax.
- Ensure hairs are trimmed to around 5mm before commencing treatment. Treat only a small area at a time as hairs in this area do not grow in one direction.
- Cut the strip to a suitable size for the bikini line area.
- Bend the leg outwards and hold the skin taut. Take note the direction of hair growth.
- Hairs in this area are often deep-seated. This may cause some small drops of blood to be drawn after waxing. Apply a cold compress made from dampened cotton wool to help soothe the area.

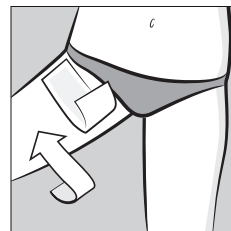

Fig. 4

### Underarm (Fig. 5)

- The underarm hair grows in 2 directions so make sure to treat in 2 sections.
- Cut the strip to a suitable size for the underarm area.
- Put one hand behind the head and stretch the arm back.
- For the upper part of the underarm apply the wax rolling up away from the centre of the underarm.
- For the lower part of the underarm apply the wax by rolling it down from the centre of the underarm.
- Hold the skin taut. For the top part, remove the strip downwards towards the centre of the underarm. For the lower part, remove the strip upwards towards the centre of the underarm.
- **IMPORTANT:** Avoid using antiperspirants or deodorants for at least 24 hours after waxing.

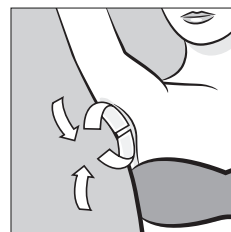

Fig. 5

### Post epilation care

- Take extra care of waxed areas, particularly after the first 24 hours. Use an antiseptic based moisturising lotion but DO NOT use perfumed lotions as these may cause allergic reactions or discomfort.
- If you notice any hairs have been missed, do not reapply wax to the treated area. Instead use tweezers to remove any remaining hairs.
- Avoid hot baths, tanning beds, saunas or other heat treatments for 24 hours after use.
- Two days after treatment begin exfoliating the area daily to help prevent ingrown hairs.
- It is recommended to wear loose fitting clothing made of natural fibres immediately after treatment to avoid irritation.
- Removal of thick/deep seated hairs e.g. underarm/bikini line may cause the appearance of small drops of blood on the skin's surface. Use a cool, damp compress to remove traces of blood and soothe the area.

## CLEANING AND MAINTENANCE

- Only use wax cartridges supplied with this product. Replacement wax cartridges (ELM-HWX101-EU) can be purchased at [www.homedics.co.uk](http://www.homedics.co.uk).
- Ensure the product has completely cooled before storing. Store the wax upright, away from a heat source. Keep away from a naked flame.
- To remove any wax residue from the case of the product, use a small amount of baby oil on a cloth. DO NOT use harsh detergents, solvents or abrasive cleaning agents. DO NOT immerse the unit in water or any other liquid. Dry thoroughly before storing.



# ELLE MACPHERSON

## THE BODY™

By  
**HOMEDICS®**



IB-ELM-HWX100-GB-0214-01